



GAAM 500 SERIES Primer

Diaphragm Priming Pump

GAAM 500 Series diaphragm pumps provide rapid, reliable pump priming and are strong, simple and positive in action.

Easy to install with standard fittings, the GAAM 500 Series pump is versatile in application and is suitable for fitting to practically any pumping unit.

Nominal times for priming suction

Hose with water* (3m static lift)

Hose ID x length	Approx priming time (seconds)
75mm x 6m	38
64mm x 6m	25
52mm x 6m	16
38mm x 6m	10

*Maximum lift = 6m

Note that the priming time and maximum Lift depend on the operator and the Mounting of the primer.

CONSTRUCTION

Body: Aluminium alloy.

Diaphragm: Fabric reinforced synthetic rubber.

N.R. Valves: Bronze.

GAAM 500 Series Diaphragm Pump Pars List

Item	Part No.	Qty.	Description
1	G0092	1	Pump Body
2	G0093	1	Top Cover
3	G0094	1	Rubber Diaphragm
4	G0095	1	Operating Handle
4a	GA-9232	1	Extension Handle (Long)
4b	GA-9134	1	Extension Handle (Short)
5	G0096	1	Upper Diaphragm Support
6	G0097	1	Lower Diaphragm Support
7	GA-9308	2	N.R. Valve
8	GA-9311	1	Screwed Nipple
9	GA-5443	1	Isolating Valve
10	GA-5390	2	Nut M4 Nyloc
11	GA-9135	1	Hand Grip
12	GA-9138	11	Screw M4 x 12
13	GA-9140	1	Screw M5 x 50
14	GA-9141	1	Screw M5 x 25
15	GA-9142	4	Steel Washer 5mm I.D.
16	GA-9143	1	Screw 1/4 BSW x 3/8
17	GA-9144	4	Nylon Washer 8mm I.D.
18	GA-9176	1	Tube 42mm
19	GA-9177	1	Tube 20mm

Complete Pumps

Short Handle Model: Part No. GA-G0102

Long Handle Model: Part No. GA-G0102LH

For best results, the primer should be mounted:

- Vertically with the handle pointing up at chest height (for operation from the back of a fire truck).
- Horizontally with the handle at knee height (for operation on portable pumpsets).





Product Shot

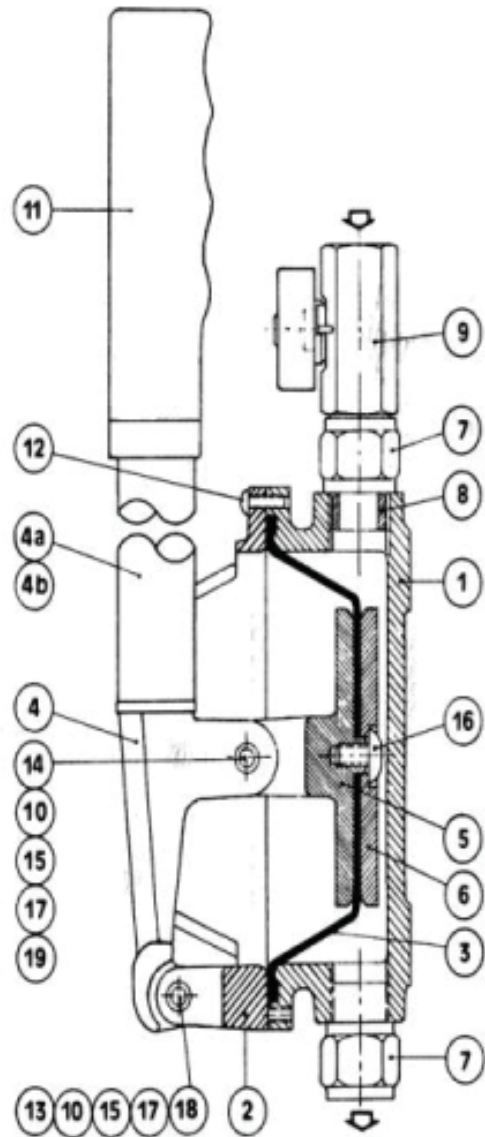

Complete Pumps

Short Handle Model: Part No. GA-G0102

Long Handle Model: Part No. GA-G0102LH

For best results, the primer should be mounted:

- (a) Vertically with the handle pointing up at chest height (for operation from the back of a fire truck).
- (b) Horizontally with the handle at knee height (for operation on portable pumpsets).

Contact Us

Phone 03 9466 1244

Email gaam.au@tycoint.com

Website www.gaam.com.au

GAAM 
Emergency Products